



Secure and Safe

Fire Alarm and Security Systems

www.se-ns.com



Conventional Resettable Manual Call Point RC-100

Introduction

The RC-100 Conventional Resettable Manual Call Point is designed for use in conventional systems for manual activation of outputs, including sounders, etc. The RC-100 call point is suitable for installation on wall in indoor environments, including residential, industrial, etc.

Installation and Wiring

Various parts of the call point are shown in the picture below. Brief description of assembling each part is provided in order:

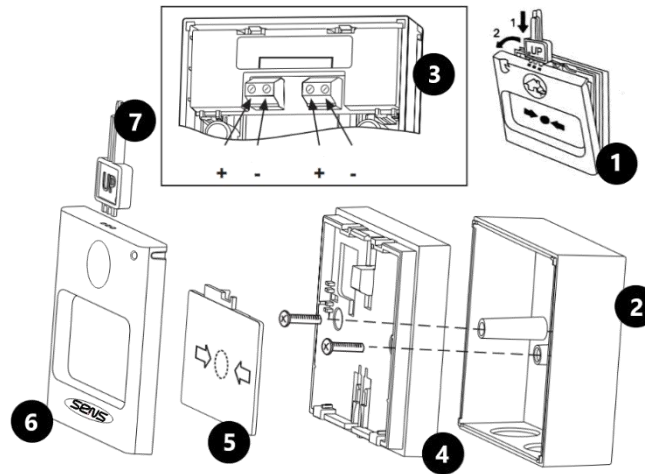

1. Disassemble the frame cover from the body using the provided key, as shown in the figure.
2. Mount the call point base onto the wall using the screws.
3. Connect zone wires to the related terminals on the element according to their polarity.
4. Attach the middle section to the base, using its screws, as shown.
5. Place the call point's unbreakable glass and its spring into their designated positions.
6. Assemble the frame cover onto the other components.
7. If needed, the call point frame cover can be removed using the provided key for maintenance, etc.

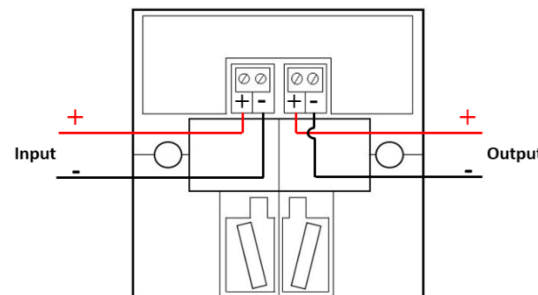

Testing

- Connect the RC-100 call point to the zone terminal of the SENS conventional control panel.
- Power on the conventional control panel.
- Press the black circle on the call point to activate it.
- The call point's LED should stay continuously light up and send a fire signal to the panel.
- Reset the call point by using the provided key to push glass back into its normal position.
- To remove the fire mode from the panel, the control panel needs to be reset.

Operating Modes	
Normal	The LED remains off.
Alarm	The LED remains continuously light up, and the mark on the breakable glass should be clearly visible.

Technical Specifications

Design Standard	EN 54-11
Power supply voltage	27V
Stand by consumption	0
Alarm state current	25mA
Operating temperature	-10 to 70 °C
Humidity	95% (without condensation)
Type	Type A (For indoor use)
Dimensions	50×95×95 mm
Weight	130gr

Warranty

Make sure this device is only used with a compatible control panel, and no destructive operations are performed on it, otherwise, it will not be covered by the warranty. Products must be regularly inspected, serviced, and maintained to ensure proper functionality.

Troubleshooting

In case of any issues with the conventional call point troubleshooting and repair of the detector parts must be done by the after-sales service department of SENS company, or an authorized representative recommended by the company.

Conventional system zone diagram

